

SAVIC

Made in Belgium



/ Geneva

Assembly instructions

Check list

Before you start assembling your cage, please check if you have all the components.
If any part is missing or damaged, do not use your cage.



- A 1 wire part
- B 2 side panels
- C 1 plastic tank
- D 1 platform
- E 1 ladder

- F 1 exercise wheel
- G 1 feeding bowl
- H 1 water bottle + holder
- I 1 connector for side panels
- J 4 non-slip feet

Instruction video



Push the 4 non-slip feet in the underside of the connector.

2

Take 1 of the 2 side panels and attach to the connector.



Click

3

Click the wire part into the side panel. Make sure it is securely fixated. Take the remaining side panel and assemble this to the wire part and the connector.



4



Install the platform on the third wire.

5



Slide in the plastic tank below the platform.

6



Fill the bottle completely with water and attach to the side of the cage so your hamster can easily reach it from the platform and add the feeding bowl. Attach the exercise wheel to the wire part and the ladder to the platform.

7



Take the plastic tank of your Geneva and fill with litter. Your Geneva is now ready for your hamster.

Make sure you close the door correctly. Place the hooks of the door over the second wire.

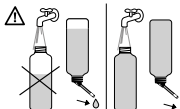

ATTENTION

To avoid leakage, always fill the bottle 100% and completely insert the metal spout into the plastic lid.



Rince spout with hot water before first use.